

**Garnes Lane, Fulbrook
Oxfordshire**

An Archaeological Watching Brief

for

Berkeley Homes

April 1997

**Garnes Lane, Fulbrook, Oxfordshire
An Archaeological Watching Brief**

by Alan Ford

Report 97/31

Introduction

This report documents the results of an archaeological watching brief carried out at Garnes Lane, Fulbrook (SP 2579 1305) (Fig. 1). The work was commissioned by Berkeley Homes (Oxford) Ltd, 20 March Road, Abingdon, Oxfordshire.

West Oxfordshire District Council granted planning permission (App. no. 1417/95) for the demolition of outbuildings and the erection of a new house with detached garage at Garnes Lane. This permission was granted with the condition that an archaeological watching brief was undertaken during groundworks on the site. This is in accordance with the Department of the Environment's Policy and Planning Guidance Note, **Archaeology and Planning** (PPG 16, 1990). The field investigation was carried out to a specification approved by Mr. Hugh Coddington, Deputy County Archaeologist for Oxfordshire County Council Archaeological Section, who advises the local planning authority in archaeological matters.

The field work was undertaken by Alan Ford on April 10th 1997 and the site code is GLF 97/31.

Location, Topography and Geology

The site is located adjacent to the west of the present village church on the northern limits of the village of Fulbrook. It is on a shallow slope at a height of c. 115 m. above OD. The underlying geology is Clypeus Grit according to the British Geological Survey (BGS 1981). However, the bedrock visible in the footings for the new house was limestone, very probably of the Chipping Norton beds.

Archaeological Background

The proposal site is adjacent to the village church in Fulbrook which is known to date from at least Late Saxon to Early Medieval times. As this church would probably have been the focus for a related village the proposal area could well produce archaeological deposits with which to document the early development of Fulbrook.

Objectives and Methodology

The purpose of the watching brief was to monitor the groundworks for the presence/absence, extent, condition, character, quality and date of any archaeological deposits within the area of development. This was achieved by inspecting the foundation trenches, following their excavation, for the presence of archaeological deposits and monitoring the spoilheaps for the presence of artefacts.

Results and Conclusion

The foundation trenches (Fig. 2) were 0.80 m. deep in the southern part of the development increasing to 1.25 m. depth to the north where the proposed building was to be recessed into a shallow hill slope. There was a uniform coverage of 0.35 m. of

topsoil overlying 0.35 m. of reddish brown 'rendzina' subsoil. This in turn overlay the limestone bedrock. No archaeological deposits were observed and no artefacts were recovered. The north western part of the development area had deliberately laid limestone within the topsoil but this was probably as a result of path laying for pre-existing caravan parking.

The total absence of any archaeological deposits or artefacts from watching brief indicates that there is unlikely to be significant archaeological activity present within the confines of the present development.

References

- BGS, 1981: **British Geological Survey**, 1:50 000, Sheet 236, Solid and Drift Edition. Keyworth.
- PPG 16, 1990: **Archaeology and Planning**. Department of the Environment. Planning Policy Guidance Note 16. (HMSO)

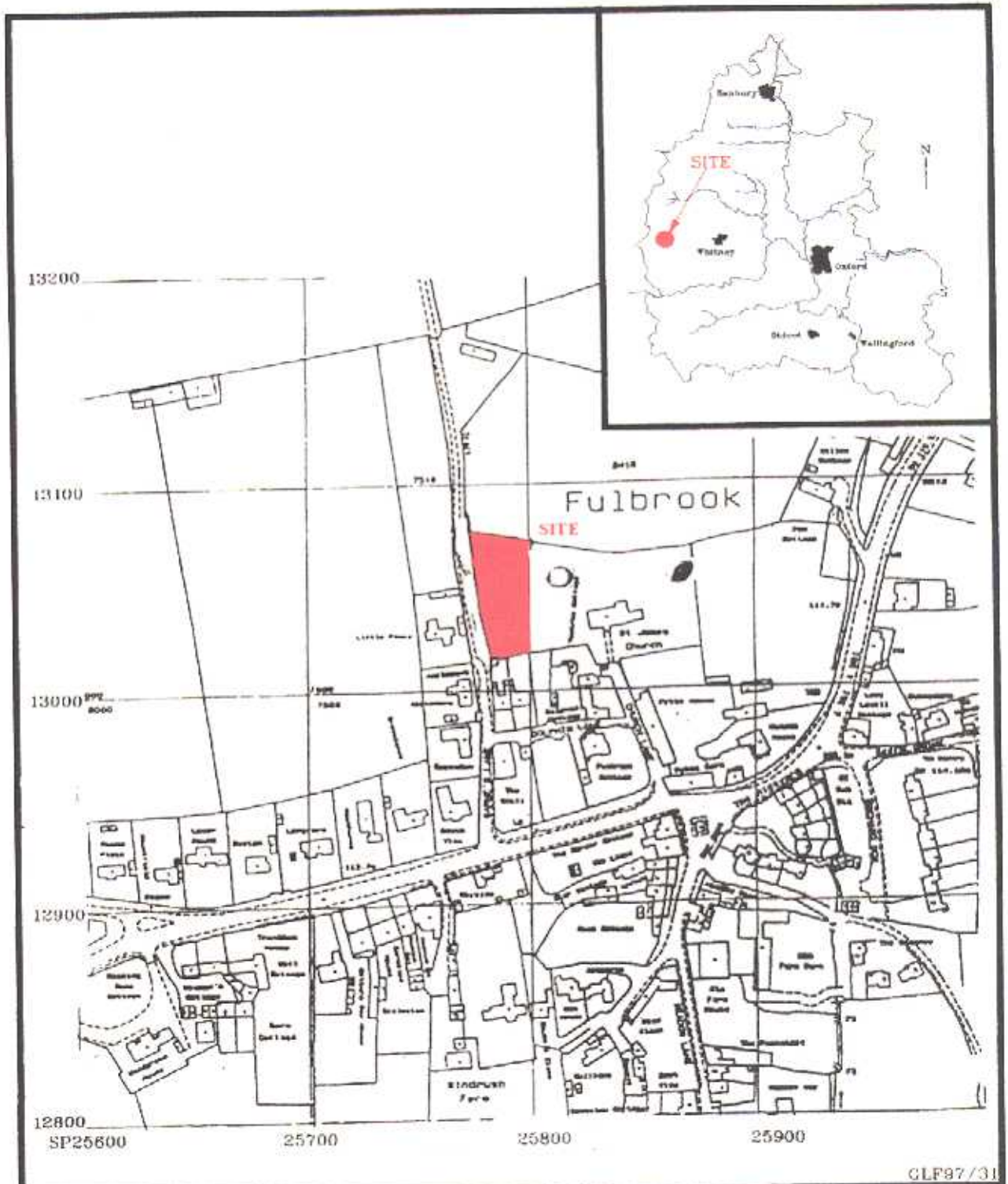

Garnes Lane, Fulbrook, Oxfordshire, 1997

Figure 1. Location of site within Oxfordshire and Fulbrook

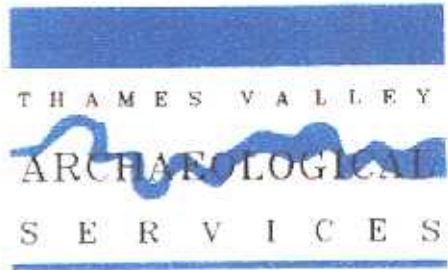

Engloved from Oxford Survey : 2000

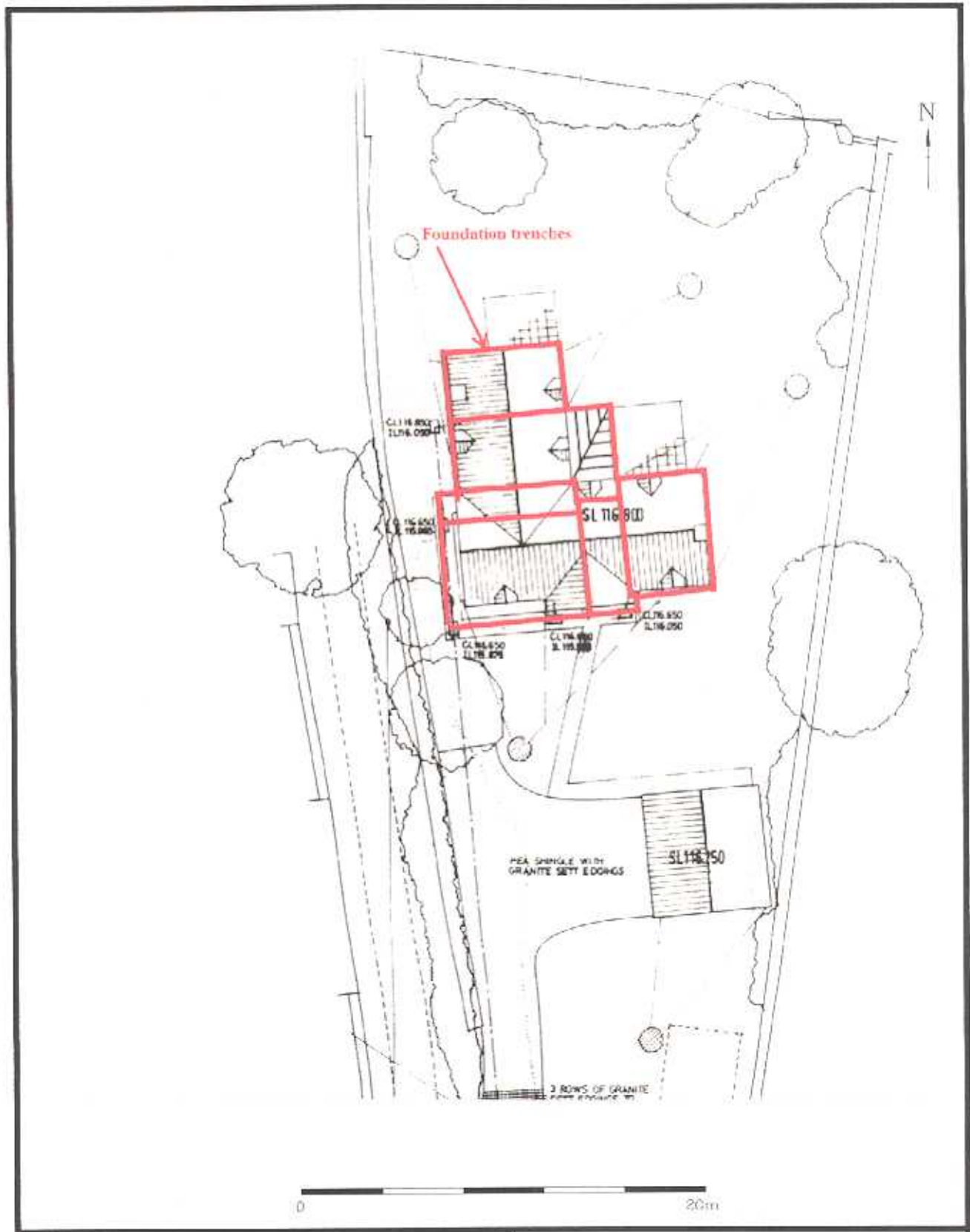

Garnes Lane, Fulbrook, Oxfordshire, 1997

Figure 2. Location of foundation trenches.

Reproduced from drawings supplied by Berkeley Homes

