

STROUD'S FARM,
LAMBOURN WOODLANDS,
BERKSHIRE

An Archaeological Watching Brief
for Earls Court Investments

Stroud's Farm, Lambourn Woodlands, Berkshire
Archaeological watching brief

Project 96/31

By Steve Ford

Introduction

This report documents the results of an archaeological watching brief commissioned by Mr. W. Bird of BK Grain Handling Engineers on behalf of Earls Court Investments as a condition on planning consent granted by Newbury District Council (no 148421) for the construction of a new access road and closure of an old one. The archaeological fieldwork was required as set out in *Archaeology and Planning* (PPG16, 1990) and was carried out in accordance with a specification agreed with Mr. H. Sherlock of Babtie Public Service Division, Archaeological Advisors to Berkshire County Council.

The watching brief was carried out during topsoil stripping by Steve Ford and Joanna Pine on the 21st and 24th June 1996. The site code is SFLW96.

Topography and Geology

The site is located just to the west of Stroud's Farm, adjacent to the B4000 at Lambourn Woodlands (SU3264 7544) (Fig. 1). The location of the new road is more or less on level ground but does slope away gently to the south. It lies on Clay-with-Flints at a height of 197 m. AOD. (BGS 1947).

Archaeological Background

The site lies adjacent to the B4000 which is thought to mark the route of the Roman road from Silchester to Cirencester (Ermin Street). It was thought possible that roadside settlement of Roman date may be present, or even parts of the Roman road itself, if for example, the current road alignment only approximately follows the earlier course. A Late Bronze Age socketed axe was also found during construction at Danesfield 500m. to the north, suggesting the

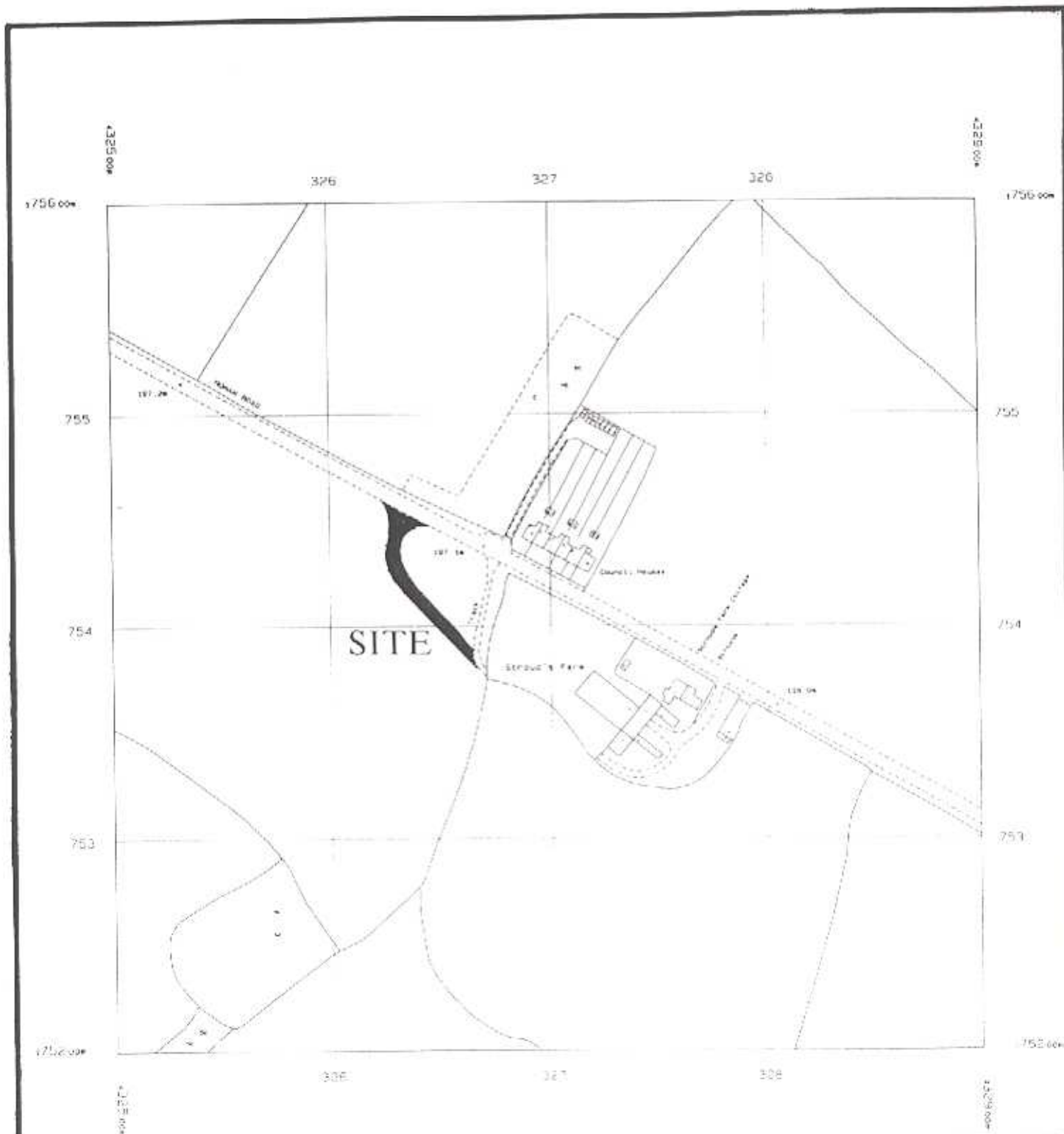

SFLW96

Stroud's Farm, Lambourn Woodlands

Figure 1. Location of site

Reproduced from O.S. Superplan centred on SU3275

THAMES VALLEY
 ARCHAEOLOGICAL
 SERVICES